

MANUAL FOR INDEPENDENT PHOTOELECTRIC SMOKE DETECTOR

I. Product profile

The photoelectric smoke detector (hereinafter referred to as the alarm) is an independent type alarm that can detect the smoke generated during a fire and issue an alarm signal in time.

The alarm device is made of photoelectric smoke-sensing device, flame-retardant engineering material shell and excellent production process. It has beautiful appearance and stable work.

Using 3.6V lithium sub-battery for power supply, low power consumption, one battery life can be more than 5 years (different use places and alarms, actual use life time may be different), with environmental self-test function and power supply under voltage prompt function.

II. Technical paramete

Humidity : $\leq 95\%$ RH (no condensation)
 Battery life : 5~10 years (depending on the number of alarms in different places)
 Power supply : DC3.6V 2700mA 14505H lithium battery
 Alarm prompt : red LED, sound and light alarm
 Alarm decibel : 85dB/m (from weak to strong incremental intermittent sounding)
 Detecting area : 20 square meters
 Working voltage : DC2.8~3.6V
 Smoke sensitivity : secondary
 Quiescent current : $\leq 5\mu\text{A}$, alarm current: $\leq 40\text{mA}$
 Working temperature : $-10\text{ }^{\circ}\text{C} \sim +50\text{ }^{\circ}\text{C}$

III. Use environment

1. Applicable place

Can be widely used in residential, leisure halls, shops, warehouses and other places where fire safety alarm monitoring is required. It is recommended to install in the center of the roof when installing, away from the dead zone.

2. Unsuitable place to install

- A. Places where dust, powder and water vapor are largely retained;
- B. Locations where corrosive gases may be generated;
- C. Garage, kitchen and places where smoke is normally staying;
- D. Where the temperature is too high and the humidity is too high;
- E vent (wind speed is greater than, 5m/s)

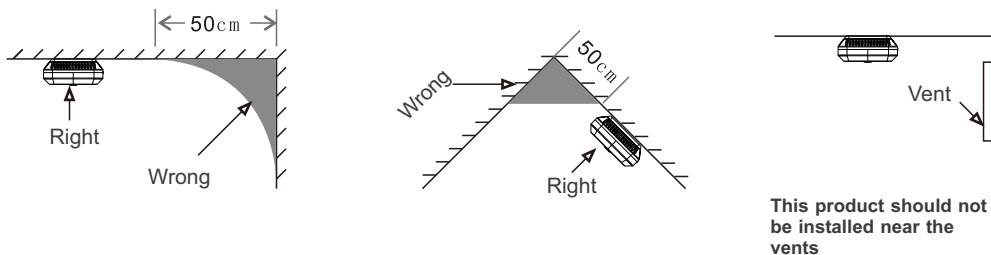

IV. Product disassembly diagram

The smoke fire alarm consists of several parts, consisting of a battery cover, a battery compartment, an alarm body and a mounting base.

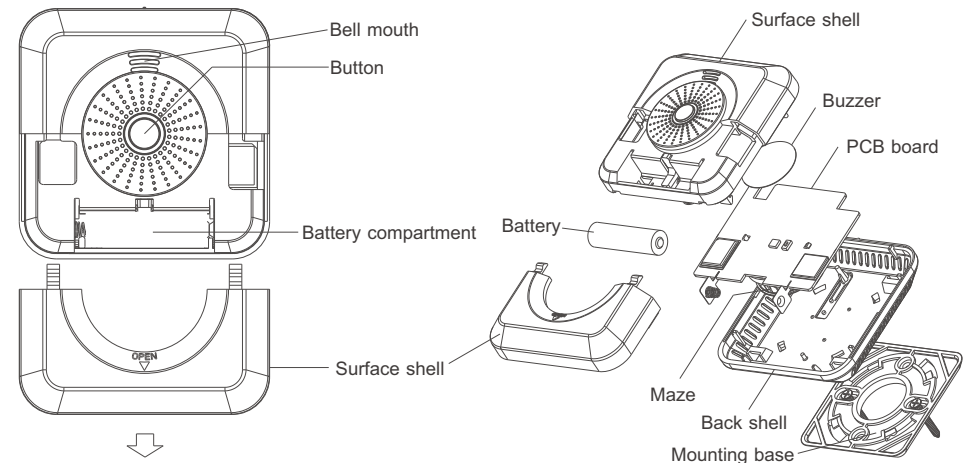

V. Installation and use

1. Product installation instructions:

When you get the product, first confirm that the package is intact and then open the package.

1.1. Open the battery compartment

After getting the alarm, first observe, find the opening direction of the alarm, grab the alarm with both hands, press the battery cover with your thumb, and push forward. As shown below:

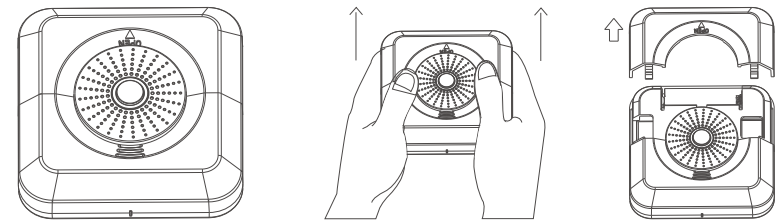

1.2. Install the battery

Install the battery after opening the battery cover. (Note that the battery is not installed correctly. If the battery is installed, the alarm will not work properly. There is an anti-battery reverse device inside the battery compartment. The battery reverse installation will not cause the alarm to be damaged. But it will cause the alarm to not work properly.) After the test equipment has no problems and is working properly, install the alarm battery cover.

1.3 After the alarm battery is installed, the test is free of any problems and the battery cover is closed. As shown in Figure 1 :

1.4. Open the mounting base: the bottom of the alarm is a separate mounting base. Grasp the base with your hand and turn it counterclockwise according to the label. As shown in Figure 2, 3:

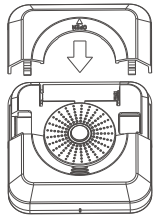

Figure 1

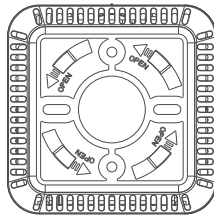

Figure 2

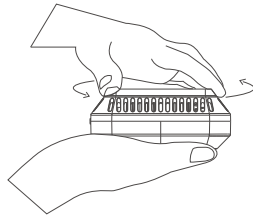
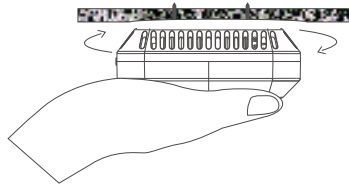
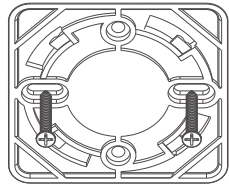

Figure 3

1.5. Installation: After the base is disassembled, place the base on the position where the button is needed, and mark the mounting hole of the base. Then mark the two holes with the corresponding mark, insert the rubber plug into the hole that has just been punched, and put the base. Fix the base with screws and finally hang the corresponding base of the alarm. See below:



2. Instructions

2.1. Indicator status description

- a) Standby state: 45S, LED flashes once.
- b) Low voltage status: flash once every minute (synchronized buzzer status).
- c) Smoke alarm status: When the smoke concentration reaches the alarm value, the LED flashes rapidly. If not dissipated, the LED will flash quickly until the smoke is dispersed or someone presses the self-test button (mute).

2.2. Buzzer description

- a) Self-test status: the buzzer sounds 3 times when it is self-tested.
- b) Low voltage state: When the battery is low pressure, it sounds every minute to indicate the battery low voltage.
- c) Smoke alarm status: When the smoke concentration reaches the alarm value, the buzzer sounds from small to large. If not dissipated, the buzzer will continue to sound until the smoke is dissipated or someone presses the self-test button (mute).

2.3. Alarm test

When working normally, press the alarm self-test button, the LED flashes 3 times and the buzzer

sounds 3 times, indicating that the self-test is successful. If you press the self-test button without any status change, please check whether the battery is normal. If the battery is not powered, please replace the battery in time.

2.4. Smoke test

In the normal working, the intermittent smoke test is performed. When the alarm detects that the smoke enters, the interval of the LED flashing is shortened from long to short (the buzzer does not ring at this time). When it is detected that the smoke concentration reaches the alarm value, the buzzer rang from small to large.

2.5. The alarm description

When the smoke exceeds the set standard value, the LED flashes and the buzzer sounds from small to large. If the smoke has not dissipated, the alarm will continue to alarm until the smoke is dissipated or someone presses the self-test button (mute).

Note: Since the alarm will consume a lot of battery power after the fire alarm, it is recommended to replace the battery after a fire or a large amount of smoke triggers the alarm to ensure the alarm can work normally.

VI. Precautions

1. Do not install the alarm in a place with high temperature, high humidity, large soot and large dust, and keep the air environment around the alarm clean.
2. Avoid installing the alarm in a place where there are a lot of paint, thinner, etc., which will produce glue suspension, etc., so as not to affect the normal monitoring of the alarm.
3. This product is a stand-alone photo-electrical smoke detection alarm. It can give an audible and visual alarm when it fires, but it can't extinguish fire. We do not recognize any legal responsibility for any property damage caused by fire.

VII. Troubleshooting

Fault phenomenon	Cause Analysis	Method of exclusion
Alarm after power-on	Serious pollution in the alarm maze	Cleaning alarm maze
	Large dust or water vapor in the alarm installation room	Wait for the smoke and water vapor to dissipate and re-power it or clean the alarm maze and then power it on again.
	Alarm circuit failure	Return to the factory for repair
"beep" sound after power-on	Battery is too low	Replace the same type of battery
	Alarm circuit failure	Return to the factory for repair
The buzzer does not ring or the volume is low after the alarm	Battery low or alarm internal circuit failure	Replace the battery. If the problem persists after replacing the battery, the internal circuit of the alarm is faulty.
Press the alarm self-test button does not alarm	The battery is not installed or the battery is dead.	If the problem is still reinstalled, please check if the battery has power, replace the battery and test again.
	Battery voltage is too low	Replace the same type of battery
	Alarm circuit failure	Return to the factory for repair
The alarm sounds once every minute	Battery low pressure alarm	Replace the same type of battery
LED lights every 45 seconds	Normal working condition	No need to deal with

VIII. Maintenance and care

1. After the alarm is installed, press the test button every month to test the alarm. If the fault is found, it should be checked in time (see Chapter 6) or returned to the factory for repair.
2. Under normal circumstances, the battery life can reach more than 5 years, but harsh environments such as high temperature and high humidity will shorten the use time.
3. When the alarm reports that the battery is under voltage, please replace the same type of battery in time. After the replacement, press the self-test button to give an audible and visual alarm prompt, which means the replacement is successful.
4. The alarm should be commissioned before installation, and should be properly kept before installation. Corresponding dust, moisture and corrosion prevention measures should be taken.
5. In the event of an alarm malfunction or other problems, do not disassemble the alarm for repair. Please disconnect the power supply and contact your local dealer for repair.
6. In the event of a fire and an alarm, it is recommended to replace the battery with a new one (if there is a fire, the alarm will keep an alarm until the smoke is gone or no electricity is stopped).